

- State-of-the-art LED technology with high luminous efficacy and long service life
- Extremely high luminaire efficacy
- Can be adjusted from a 1.5 to a 3.0 h rated operating time
- Luminous flux after 100,000 h still 90% of the starting luminous flux
- Optionally with DALI for controlling and monitoring the light fitting
- Automatic weekly functional test and annual rated operating time test

MY R. STAHL 6009D



The emergency luminaire with Series 6009/4 LED with integrated battery can be installed in stand-by switching, continuous mode or in switchable stand-by switching. A weekly functional test and annual rated operating time test are performed automatically. The results are indicated by an LED.

	IECEX / ATEX					
Zone	0	1	2	20	21	22
Installation in		•	•		•	•

Selection Table								
Size			2					
Lamp wattage			25 W					
Luminaire efficacy			116 lm/W					
Luminous flux			2910 lm					
Drilled holes	Threaded plate	Light colour	Cable glands and entries	Stopping plugs	Through wiring	Product Type	Art. No.	Weight
3 x M20	2x SS430 stainless steel	5000 K – neutral white	can be ordered as an accessory	Can be ordered as accessories	With 6 conductors 2.5 mm ²	6009/4128-2103-162-2220-22-850011	267868	6.7 kg
3 x M25	2x plastic	5000 K – neutral white	2 x M25 Ø 7 ... 17 mm	2 x M25 x 1.5	With 6 conductors 2.5 mm ²	6009/4128-2103-162-1110-11-850011	267867	6.65 kg
Size			4					
Lamp wattage			45 W					
Luminaire efficacy			129 lm/W					
Luminous flux			5810 lm					
Drilled holes	Threaded plate	Light colour	Cable glands and entries	Stopping plugs	Through wiring	Product Type	Art. No.	Weight
3 x M20	2x SS430 stainless steel	5000 K – neutral white	can be ordered as an accessory	Can be ordered as accessories	With 6 conductors 2.5 mm ²	6009/4148-2103-162-2220-22-850011	267875	9.2 kg
3 x M25	2x plastic	4000 K – warm neutral white	2 x M25 Ø 7 ... 17 mm	2 x M25 x 1.5	With 6 conductors 2.5 mm ²	6009/4148-2103-162-1110-11-840011	282811	9.2 kg
		5000 K – neutral white	2 x M25 Ø 7 ... 17 mm	2 x M25 x 1.5	With 6 conductors 2.5 mm ²	6009/4148-2103-162-1110-11-850011	267872	9.2 kg
Product variant			Interfaces DALI					
Size			2					
Lamp wattage			25 W					
Luminaire efficacy			116 lm/W					
Luminous flux			2910 lm					
Drilled holes	Threaded plate	Light colour	Cable glands and entries	Stopping plugs	Through wiring	Product Type	Art. No.	Weight
4 x M25	2x plastic	5000 K – neutral white	2 x M25 Ø 7 ... 17 mm	2 x M25 x 1.5	With 8 conductors 2.5 mm ²	6009/4128-2113-182-1111-11-850011	286432	6.55 kg

Variants with 2 x threaded plate plastic and 3 x drilled holes M25:





Cable glands 2 x M25 Ø 7-17 mm and 2 x stopping plugs M 25 x 1,5 are included loose with the product (installation required). Threaded plate included.

Variants with 2 x threaded plate stainless steel SS430 and 3 x drilled holes M20:

Cable glands and stopping plugs can be ordered as accessories. Threaded plate included.

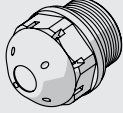
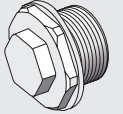
The light fittings are supplied without mounting material.

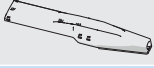
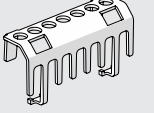
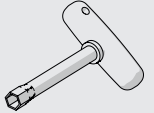
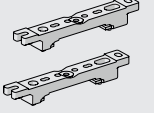
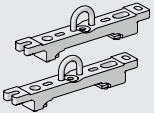
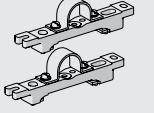
Technical Data		
Variant	Size 2	Size 4
Explosion Protection		
IECEx gas explosion protection	Ex db eb ib op is IIC T4 Gb	Ex db eb ib op is IIC T4 Gb
IECEx dust explosion protection	Ex tb op is IIIC T100 °C Db	Ex tb op is IIIC T100 °C Db
ATEX gas explosion protection	⊕ II 2 G Ex db eb ib op is IIC T4 Gb	⊕ II 2 G Ex db eb ib op is IIC T4 Gb
ATEX dust explosion protection	⊕ II 2 D Ex tb op is IIIC T100 °C Db	⊕ II 2 D Ex tb op is IIIC T100 °C Db
Note: Through wiring	Max. 3x16 A	Max. 3x16 A
Note: Through wiring 2	Max. 3x10 A	Max. 3x10 A
Certificates	ATEX (IBE), IECEx (IBE), India (PESO), Polen (CNBOP)	ATEX (IBE), IECEx (IBE), India (PESO), Polen (CNBOP)
Ship approval	DNV	DNV
Declaration of conformity	ATEX (EUK), Declaration of Conformity (AUS)	ATEX (EUK), Declaration of Conformity (AUS)
Electrical Data		
Rated operational voltage AC	100 ... 240 V	100 ... 240 V
Battery operating voltage	6 V	6 V
Battery capacity	7 Ah	7 Ah
Frequency range	50 – 60 Hz	50 – 60 Hz
Battery version	NiCd battery, gas-tight	NiCd battery, gas-tight
Ambient Conditions		
Ambient temperature °C	-30 – 50 °C	-30 – 50 °C
Lighting Data		
Number of lamps	1	1
Lamp	LED	LED
Light distribution	120°x120° with diffusing glass	120°x120° with diffusing glass
Operating time	1.5 / 3h emergency lighting operation	1.5 / 3h emergency lighting operation
Emergency light output	35% – 3 h 65% – 1.5 h	20% – 3 h 35% – 1.5 h
Colour rendering	≥ 80	≥ 80
Mechanical Data		
Enclosure material	Polyester resin, Glass fibre reinforced	Polyester resin, Glass fibre reinforced
Diffuser	With diffuser	With diffuser
Sealing material	Silicone	Silicone
Installed terminal strip	PE + N + L1 + L2 + L3 + L´	PE + N + L1 + L2 + L3 + L´
Max. solid connection terminals	6 mm²	6 mm²
Max. finely stranded connection terminals	4 mm²	4 mm²
Type of connection cable	Finely stranded Solid	Finely stranded Solid
Impact strength (IEC 62262)	IK10	IK10
Enclosure colour	Light grey (RAL 7035)	Light grey (RAL 7035)
Notes	Connection terminals: Spring clamp terminal (2 free clamping units per pole)	
Components		
Ballast	6046/311-121-010	6046/311-121-010
Cable entry material	Polyamide, black	Polyamide, black
Stopping plug material	Polyamide, black	Polyamide, black

Accessories			
Figure	Description	Art. No.	Weight
Breather			
	Thread: M25 x 1.5 (20 pieces); without jam nut	285780	200 g
	Thread: M25 x 1.5 (1 piece); for installation in light fittings; made from stainless steel; without jam nut	296608	76 g
Holder for translucent cover			
	The fall prevention system for the light fitting cover prevents the light fitting cover from falling accidentally when the light fitting is opened.	226791	21 g
Pole mounting sleeve			
	for the subsequent mounting on lights size 2 and size 4, completely with assembly parts (for pipe diameter 42 mm)	227512	3.2 kg
Protection against accidental contact			
	The protection against accidental contact prevents maintenance technicians and electrical installers from accidentally touching conductive parts. The degree of protection is increased to IP20 when the protection against accidental contact is used.	283153	14 g
Box spanner			
	M8 / A/F 13; For actuating the central lock	222430	110 g
Mounting rail			
	for a variable mounting distance; 1 pair	222826	350 g
Mounting bracket			
	mounting clamp mounted on a mounting rail for a variable mounting distance; 1 pair	222456	400 g
Pipe clamp			
	R 1 1/2"; with mounting rail for a variable mounting distance; material: stainless steel; 1 pair	222459	700 g
	R 1 1/4"; with mounting rail for a variable mounting distance; Material: stainless steel; 1 pair	222458	700 g
	R 2"; with mounting rail for a variable mounting distance; Material: stainless steel; 1 pair	222460	750 g
Ring bolt			
	M8, direct mounting in insert nuts; 1 pair	115736	115 g

Accessories

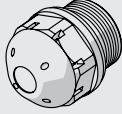
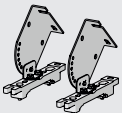
Figure	Description	Art. No.	Weight
Breather			
	M25 x 1.5 in order to avoid condensate formation	115738	17 g
Ceiling and wall mounting bracket			
	mounted on a mounting rail for a variable mounting distance; Material: stainless steel; Lamp can be swiveled in steps of 15°; 1 pair	222827	1.2 kg

Spare Parts

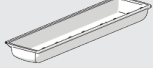
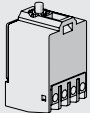
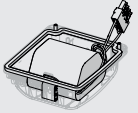
Figure	Description	Art. No.	Weight
Cover			
	for luminaire size 4	222428	1.15 kg
	for luminaire size 2	222427	639 g
Contact element			
	8080/1-3-L 2 NC contact element	132527	26 g
Battery set			
	Battery cover with built-in battery. Gas-tight NiCd battery; 7 Ah / 6 V	223532	1.2 kg

Dimensional Drawings (All Dimensions in mm [inches]) – Subject to Alterations

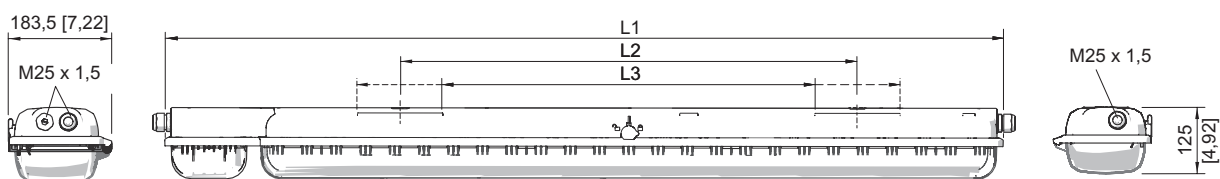

Size 2:
 L1 = 857 mm [33.74]
 L2 = 400 mm [15.75]
 L3 = 320 ... 480 mm [12.60 ... 18.90]

Size 4:
 L1 = 1467 mm [57.76]
 L2 = 800 mm [31.50]
 L3 = 670 ... 930 mm [26.38 ... 36.61]

Emergency luminaire with LED EXLUX

Series 6009/4



E2

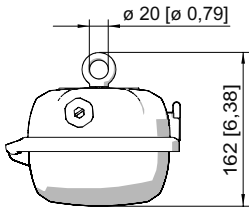

Ring bolt fitted in insert nut of the luminaire

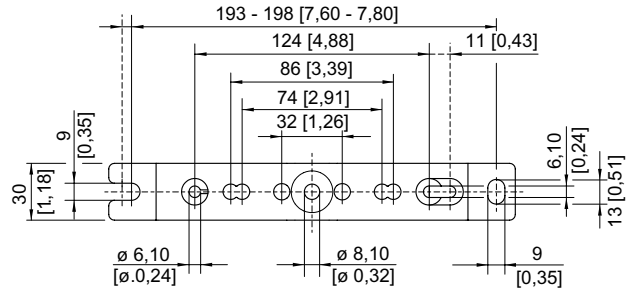
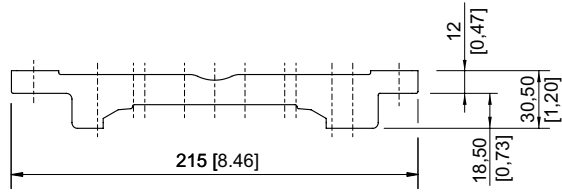

Mounting rail

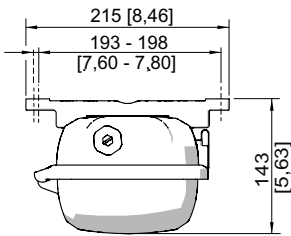

Mounting rail

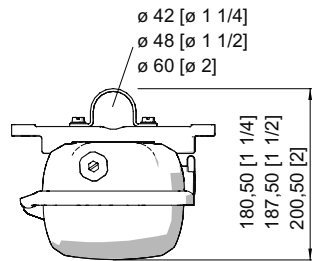

Pipe clamp fitted in mounting rail

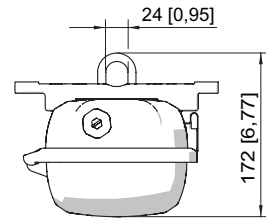

Mounting bracket fitted in mounting rail

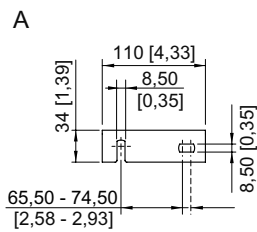
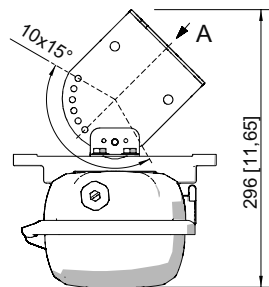

Wall mounting bracket fitted in mounting rail

E2

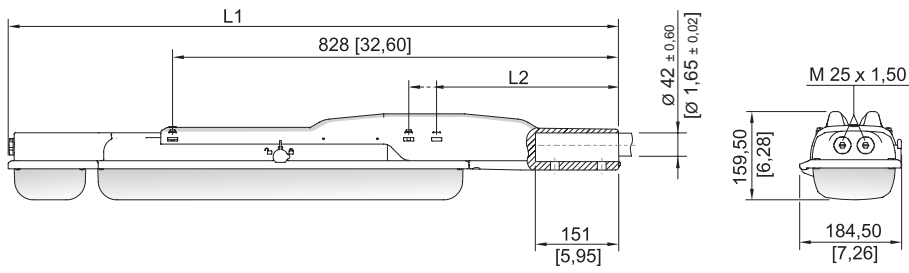

With pole mounting sleeve

Size 2:

L1 = 1133 mm [44.61]

L2 = 390 mm [15.35]

Size 4:

L1 = 1742 mm [68.58]

L2 = 338 mm [13.31]